

SAFETY PIN COMPONENTS

PAGE	DATE	NAAMS CODE	DESCRIPTION
AA-1	04/20/12		Safety Pin Components Index
AA-2	04/20/12	ASC0010	Safety Pin Tap Pad
AA-3	04/20/12	ASC0011	Safety Pin Mounting Bracket
AA-4	04/20/12	ASC0100, 0150, 0200, 0250, 0300	Safety Pin

SAFETY PIN TAP PAD ASC0010

EXCEPT AS NOTED TOLERANCES SHALL BE:

- 1 PLACE MACHINING ± 0.3
- 1 PLACE FABRICATION ± 1.5
- 2 PLACE ± 0.08 BETWEEN MACHINED SURFACES
 ± 0.13 TO SCREW HOLES, NON ACCUMULATIVE

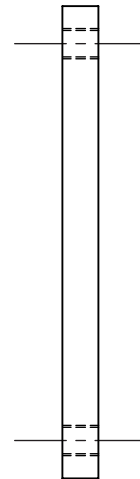
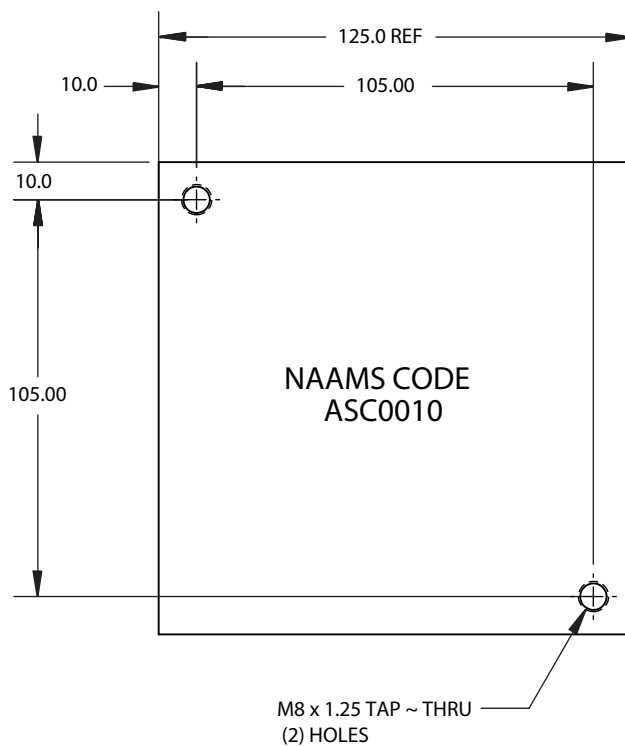

1-REQ'D - SAE 1020 - 3/8" x 5" x 125.0 mm

SAFETY PIN

ASC0100, ASC0150, ASC0200 TM
ASC0250, ASC0300

GLOBAL STANDARD COMPONENTS

NAAMS



Assembly

04/20/12

EXCEPT AS NOTED TOLERANCES SHALL BE:

- 1 PLACE MACHINING ± 0.3
- 1 PLACE FABRICATION ± 1.5
- 2 PLACE ± 0.08 BETWEEN MACHINED SURFACES
 ± 0.13 TO SCREW HOLES, NON ACCUMULATIVE

NAAMS CODE	"Y"	"Z"
ASC0100	100	145.0
ASC0150	150	195.0
ASC0200	200	245.0
ASC0250	250	295.0
ASC0300	300	345.0

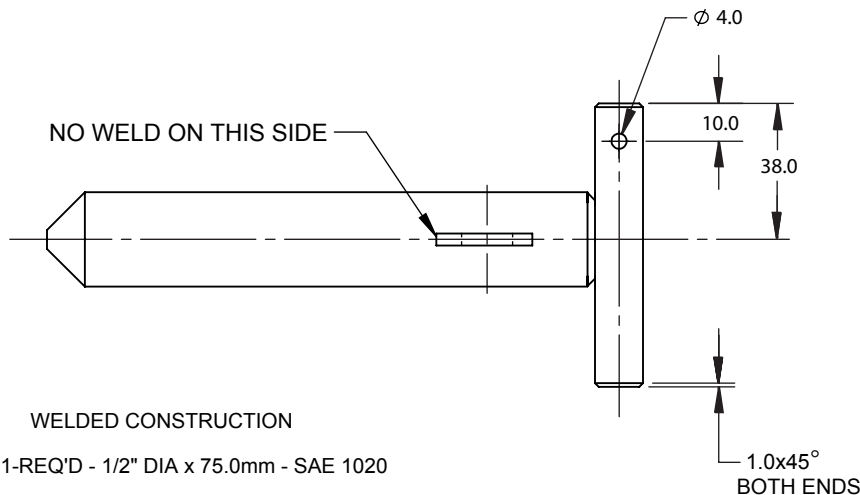
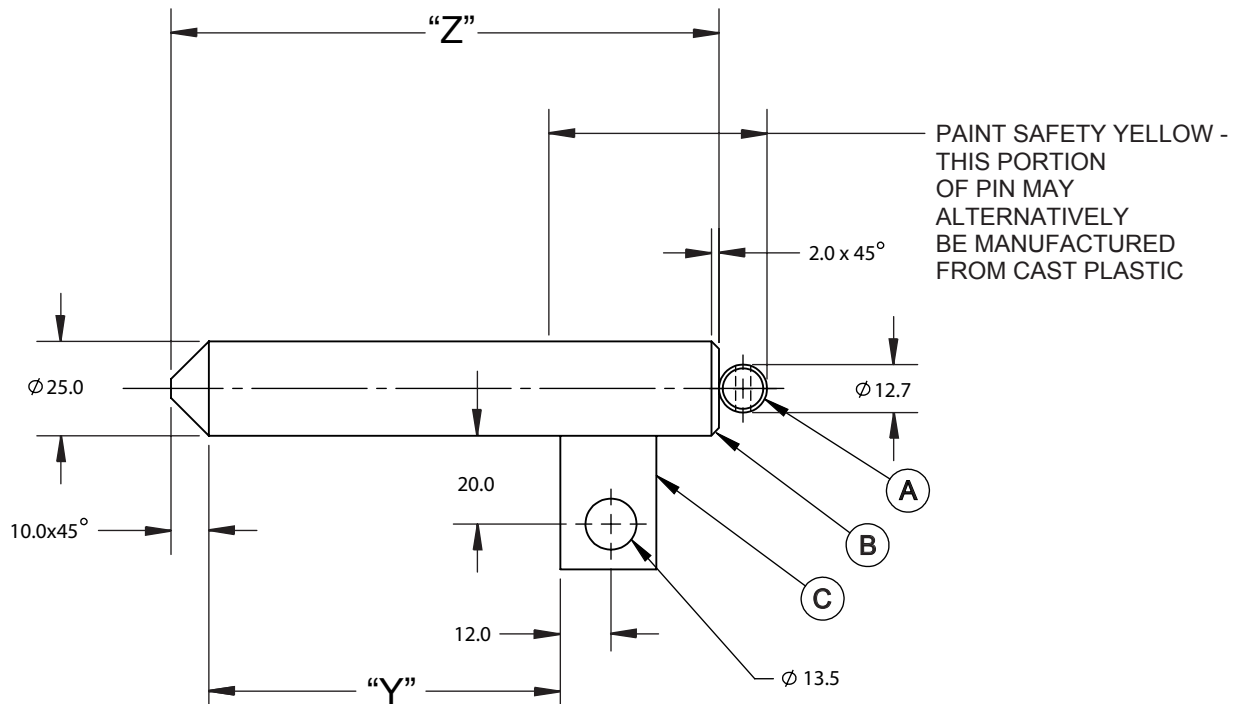

WELDED CONSTRUCTION

- (A) 1-REQ'D - 1/2" DIA x 75.0mm - SAE 1020
- (B) 1-REQ'D - 1" DIA x "Z" - SAE 4140
- (C) 1-REQ'D - 1/8" x 1" x 32.0mm - SAE 1020

12,000 lbf (5443 kgf) STATIC SINGLE SHEAR STRENGTH
(INCLUDING A 3:1 SAFETY FACTOR)